



A/22 Piezoelectric Accelerometer

26pC/g nom.

12gm

250°C Max Temp

The Konic shear sensing element of the A/22 incorporates a mechanically isolated central sleeve that comprises part of the transducer casing, thus providing an annular through hole for attachment.

The feature allows 360° connector orientations and minimizes height, thus facilitating installation. In addition all welded construction and total absence of epoxies maximizes reliability and temperature range.

The A/22 provides an output comparable that of the A/20, with the advantage of 50% reduced height and total freedom of cable orientation.

Options

- Close tolerance output. Wideband temperature calibration 50°C/250°C
- Hermetic connector not available
- Insulated mounting kit, SI/22 provides electrical isolation, minimising common mode interference

A/22

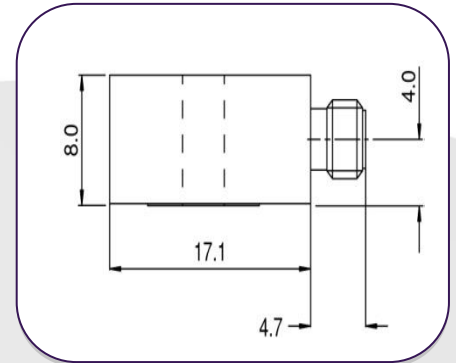

SI/22

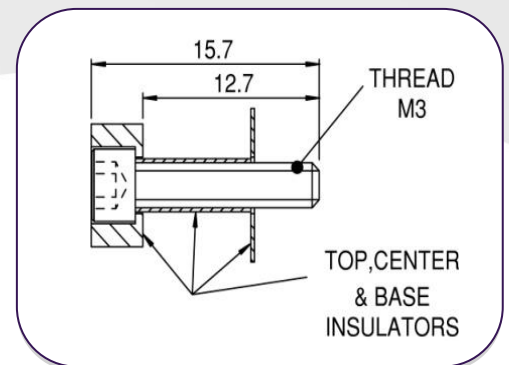

Typical Frequency Response

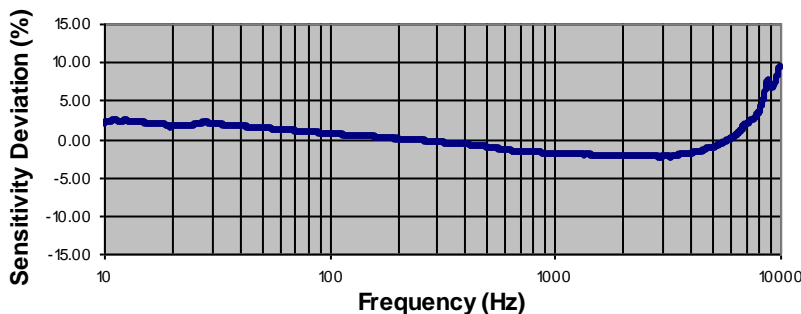

Temperature

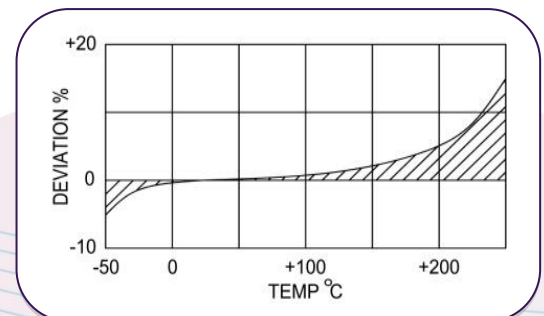

A/22 Piezoelectric Accelerometer

26pC/g nom.

12gm

250°C Max Temp



	Metric		Imperial	
Charge sensitivity nom.	2.04pC/(m/s ²)	3.22pC/(m/s ²)	20pC/g	32pC/g
Capacitance pF	1300	1900	1300	1900
Resonant Frequency KHz	≈20		≈20	
Cross Axis error % max	5		5	
Temperature Range	-50/+250°C		-58/+482°F	
Charge sensitivity deviation re 20 °C	-5% @ -50°C +15% @ +250°C		-5% @ -58°F +15% @ +482°F	
Frequency Response	1Hz – 9KHz, ±5% 1Hz – 10KHz, ±10%		1Hz – 9KHz, ±5% 1Hz – 10KHz, ±10%	
Maximum Continuous 'g level	9,807m/s ²		1000g	
Case Material	s/steel 303 S31		s/steel 303 S31	
Mounting	M3.5 Through hole, SI/22		M3.5 Through hole, SI/22	
Connector	10-32 UNF Microdot		10-32 UNF Microdot	
Weight	12gm		120.42oz	
Size	17.2 x Ø16 x 8.1mm		0.68 x Ø0.63 x 0.32in	

DJB Instruments (UK) Ltd

Finchley Avenue,
Mildenhall, Suffolk IP28 7BG

A UK company with UK-based manufacturing, assembly and calibration in-house.

Tel +44 (0)1638 712 288
Email sales@djbinstruments.com
Web www.djbinstruments.com

DJB Iss.1

